

PLATFORM MATERIAL TAKEOFF

10-2x8-8' FT FLOOR JOISTS
 2-2x8-10' FT FLOOR JOISTS
 3-2x8-12' FT FLOOR JOISTS
 14 2x8 JOIST HANGERS
 4 DOUBLE 2x8 JOIST HANGERS
 51 LIN. FT. $\frac{3}{8}$ "x5" PLYWOOD STRIP
 (INCLUDED WITH YURT)
 101 LIN. FT. $\frac{3}{4}$ "x1 $\frac{1}{2}$ " PLYWOOD STRIP
 7 SHEETS $\frac{3}{4}$ "x4'x8' PLYWOOD SUBFLOOR

NOTE:
 DEPENDING ON GRADE,
 ENGINEERING REQUIREMENTS &
 LOCAL CODES, FOUNDATION
 BRACES MAY BE REQUIRED-
 BRACES NOT SHOWN

FOUNDATION MATERIAL TAKEOFF

7-12" DIAMETER CONCRETE
 SONOTUBE PIERS
 7-6x6 FT POSTS (LENGTH TO BE
 DETERMINED BY GRADE)
 7-SIMPSON ABE66 POST
 ANCHORS
 3-SIMPSON BC52-3/6 POST CAPS
 24- $\frac{3}{8}$ "x8" HOT DIPPED GALV.
 CARRIAGE BOLTS, WASHERS, &
 NUTS
 6-2x8-8' FT GIRDER JOISTS
 12-2x8-8' FT RIM JOISTS

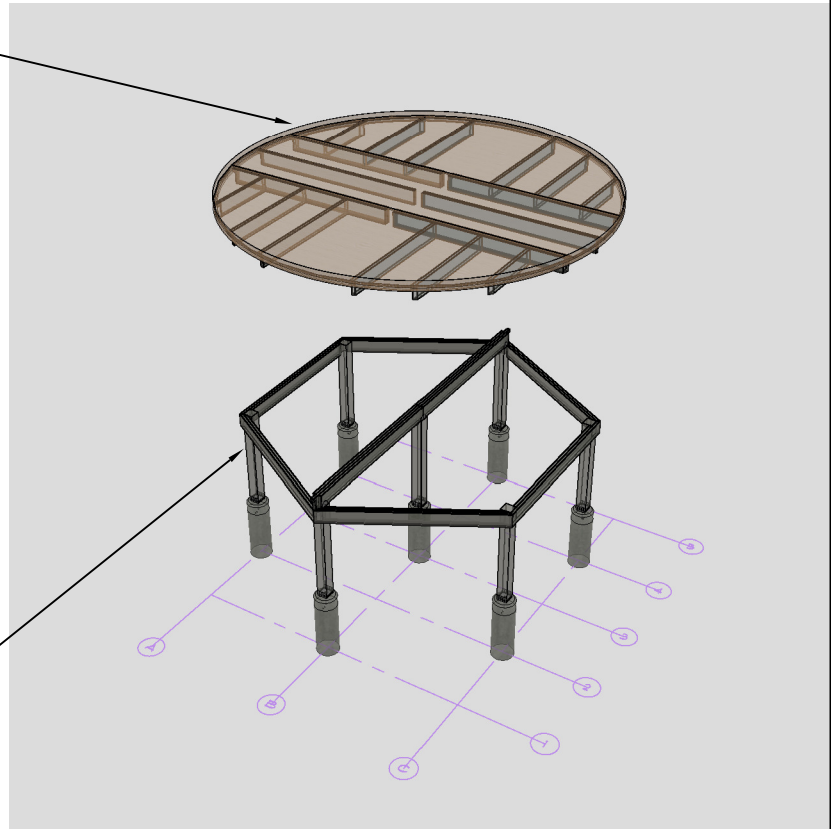

4 Material Takeoff

SCALE NTS

16' Yurt Platform
 Material Takeoff



369 Parkway Lane South
 Floyd, VA 24091
 540.745.7458
 blueridgeyurts.com

SHEET NUMBER
 16'-4b